



Santa Fe Insert shown with 24-karat gold trim, optional log set and extra top log.

**FIRE
STRENGTH
BEAUTY**

The Santa Fe Insert comes standard with classic black trim—and can be further customized with 24-karat gold, satin nickel or black nickel finishes.

SANTA FE INSERT

Add high efficiency and delicious warmth to your room with the Santa Fe Pellet Insert. The sleek, contemporary design adds elegant style to your fireplace and the soft, relaxed lines blend easily into the décor of any home.

Quadra-Fire's patented self-lighting ignition and jam-free feed systems ensure trouble-free operation. And, the exclusive combustion technology offers high efficiency, giving you quiet, steady, comfortable heat throughout your room. Enjoy the drama of fire and the personal satisfaction of heating with a renewable resource.

QUADRA-FIRE[®]
NOTHING BURNS LIKE A QUAD





SANTA FE INSERT

DIMENSIONS

PANEL SIZES

PANEL	A	B
Standard	30	40
Large	33	50

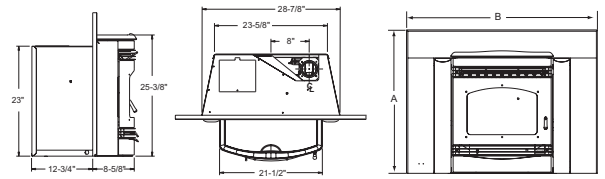

CLEARANCES

MASONRY & ZERO CLEARANCE** FIREPLACES

A	Insert side to combustible side wall	16"
B	Insert top to mantel	12"
C	Insert top to max 2.25" face trim	4-3/4"
D	Insert side to max 2.25" face trim	10"
E	Floor protection hearth extension from door opening	6"
F	Floor protection to the side of door opening	6"

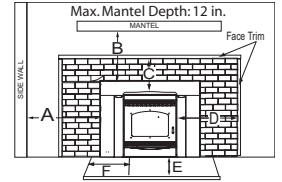

BUILT-IN FIREPLACE

A	Top of Hopper	Top Vent	2"
		Rear Vent	2-1/2"
B	Side of Hopper	Top/Rear Vent	2"
C	Back of Hopper	Top/Rear Vent	2-1/2"

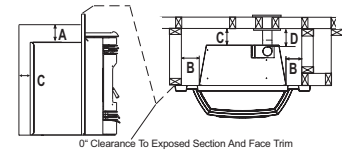

MINIMUM FIREPLACE OPENING

A	Back Width	24"
B	Depth	16"
C	Height	23-1/4"
D	Front Width	29-1/4"

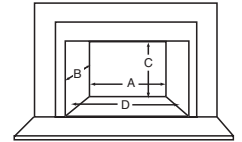

TECHNICAL

Heating Capacity*up to 1,500 sq. ft.
BTU Output.....	8,000–30,000/hr.
Hopper Capacity	45 lbs.
Burn Rate.....	1.5–4 lbs./hr.
Fuel	Wood Pellets or Shelled Corn
Shipping Weight.....	214 lbs.

Quadra-Fire offers a Limited Lifetime Warranty on our pellet heating appliances to the original purchaser for the lifetime of the appliance, to be free from defects in material and workmanship. For full warranty details go to www.quadrafire.com



Refer to the Owner/Installation Manual for complete clearance requirements and specifications. The images and descriptions in this brochure are provided to assist you in product selection only. *Heating capacity rating is to be used as a guideline only and may differ slightly due to climate, building construction and condition, type of fuel, amount and quality of insulation, location of the heater, and air movement in the room. **Zero Clearance not authorized for installation in Canada.

Quadra-Fire is a registered trademark of Hearth & Home Technologies. Product specifications and pricing subject to change without notice. The Quadra-Fire Santa Fe Pellet Insert is tested and listed with OMNI Test Laboratories, Inc., of Beaverton, Oregon to ASTM E1509 and ULC/ORD-C1482 Room Heater Pellet Fuel Burning type and (UM) 84-HUD, Mobile Home Approved.

Available From:



Fresh Contemporary Design

Soft lines, fashionable handles, ergonomic controls and superior heating performance make the Santa Fe Insert an excellent choice for today's design-conscious consumer.

Simple Operation

Fully automatic, self-lighting and featuring a jam-free feeder system, the Santa Fe Insert ensures reliable, hassle-free performance. The integrated controls are simple and easy to use.

Fireplace Insert or Zero Clearance** Installation

The charming Santa Fe Insert can be used to convert an existing fireplace to an efficient and beautiful home-heating system. It can also be installed as a "zero clearance" unit—no existing fireplace is needed.

Standard Features

- Classic black finish
- Cast iron herringbone brick fireback
- Burns wood pellets or shelled corn—a renewable fuel
- Three heat settings
- Aluminum heat exchanger—high heat transfer
- Convenient "Pull & tip" hopper access for fuel loading
- Variable heat control: 8,000 to 30,000 BTU/hr

Options

- Two panel set sizes with gold or black nickel trim
- Window trim in gold, satin nickel or black nickel
- Grille in gold, satin nickel or black nickel
- Four-piece log set
- Additional fifth top log available
- Programmable wall thermostat
- Remote control thermostat

QUADRA-FIRE®

NOTHING BURNS LIKE A QUAD

1445 North Highway, Colville, WA 99114
www.quadrafire.com • 800-234-2508